

CONTAINER

MULTI LUG BEAM BMC

MAIN CHARACTERISTICS

The Container Multi Lug Lifting Beam is designed for lifting ISO-668 maritime containers as well as general industry use, providing an additional solution for hoisting any other longitudinal load. **It is available in three models with capacities of 15, 24, and 34 tons respectively, all with a maximum usable length of 2.5 meters**, that allows lifting a maritime container of any size in a transverse position (20, 25, 40, 45 feet) as well as other containers, platforms... that include specific twist-lock type accommodations in their lower corners.

IMPORTANT NOTE:

ISO-668 standard sea containers with cargo can only be lifted by the lower twistlock accommodations. If you need to lift them through the upper twistlocks, you can do so with an type H lifting beam a Spreader Beam FRAME and vertical Twistlocks.

Container Multi Lug Lifting Beam for containers is conceived to facilitate the lifting of ISO-668 maritime containers of all sizes through its lower attachments. Additionally, it can function as a conventional multi-drill spreader. Hence, it offers a versatile solution for lifting loads with a crane, providing multiple lifting configurations:

- At the top: It can be used with a central single-point attachment for situations with limited heights or with a two leg sling if there is sufficient height, providing greater stability. It can even be used to combine two cranes to lift loads that exceed the individual capacity of the cranes.
- At the bottom: It features a continuous pattern of holes that allows for adjusting the position of the load center with reasonable precision. Additionally, as it is designed for lifting maritime containers, it has transverse ears slightly elevated and positioned at the width of the container, allowing for attachment and lifting using four chain-cables with a specific twistlock attachment for the container's lower side, enabling lifting the container from the base.

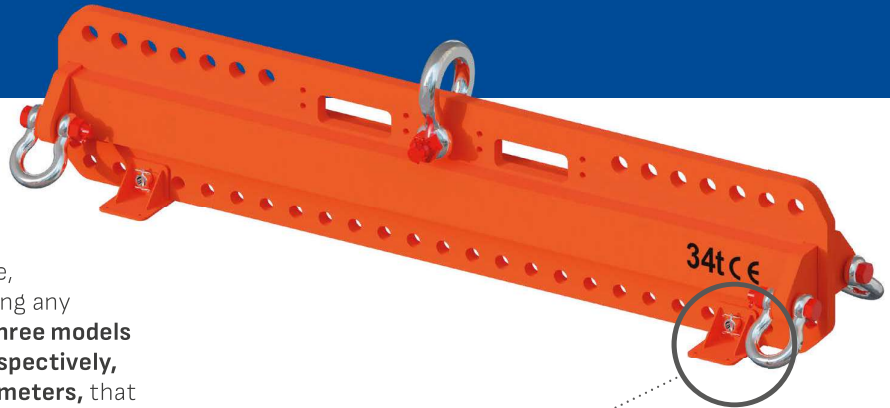

Optional support leg

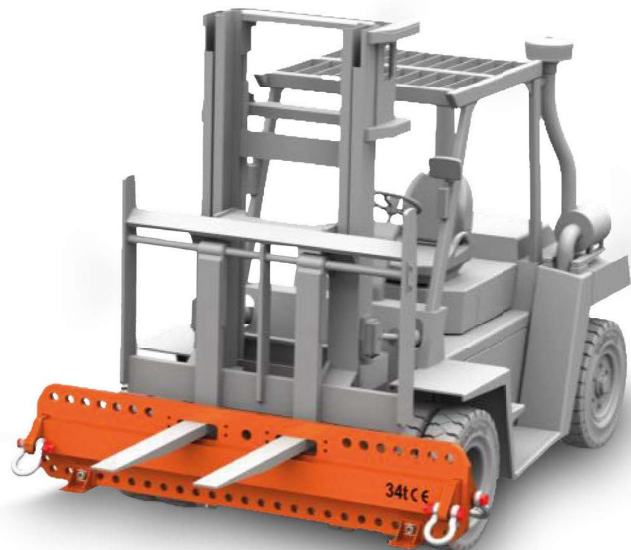

Forklift Pocket System



ADVANTAGES

- Versatility for lifting both ISO maritime containers and general industry loads. It provides an additional solution for hoisting any other longitudinal cargo intended for transport on a conventional truck platform, capable of lifting with oblique pulls or using two units.
- Allows adjustment of the load center both longitudinally and transversely through the supplied accessories, tailored to each specific need.
- It incorporates a Forklift Pocket system only for handling.
- Optionally equipped with additional support legs.
- Units available in stock for immediate delivery unless sold out.



Twistlocks

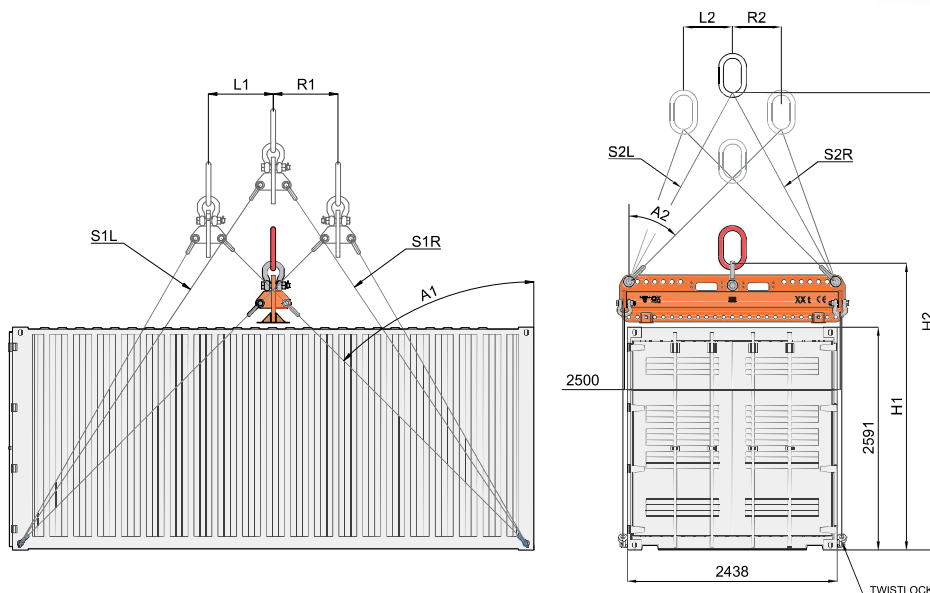

Adjustment of the load's center of gravity (COG)

MULTI LUG BEAM BMC

SPECIFICATIONS

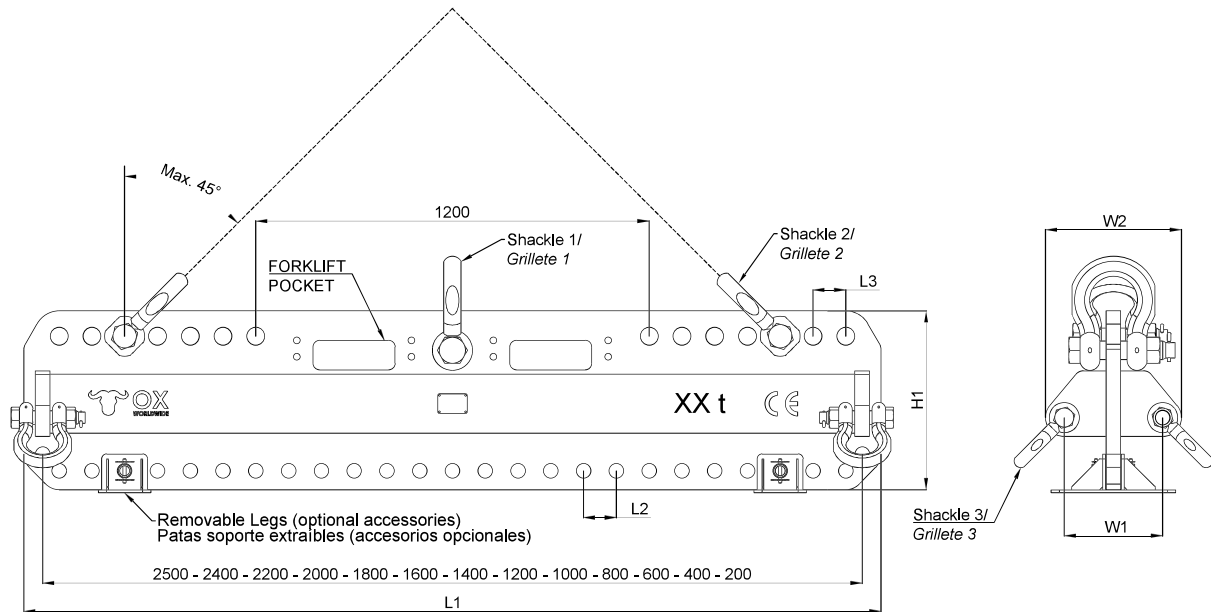

| W.L.L. | L (mm) | CODE | L1 (mm) | L2 (mm) | L3 (mm) | H1 (mm) | W1 (mm) | W2 (mm) | Shackle 1 | Shackle 2 | Shackle 3 | WEIGHT (kg)* | SUPPORT LEG |
|--------|-----------|---------------|------------|------------|------------|------------|------------|------------|--------------|--------------|--------------|-----------------|---------------|
| 15t | 2500 | 831BMC2015025 | 2590 | 100 | 100 | 426 | 300 | 390 | 17t | 12t | 8.5t | 346 | 831BMP2015035 |
| 24t | 2500 | 831BMC2024025 | 2610 | 100 | 100 | 472 | 300 | 410 | 25t | 17t | 12t | 462 | 831BMP2024045 |
| 34t | 2500 | 831BMC2034025 | 2615 | 100 | 100 | 546 | 300 | 410 | 35t | 25t | 17t | 566 | 831BMP2034045 |

* Weight without accessories

ACCESSORIES SUPPORT LEGS

The new accessories allow the support of the Multi Lug Lifting Beam. They are removable elements, interchangeable in any of the lower holes and that do not interfere with the normal operation of the Multi Lug Lifting Beam.

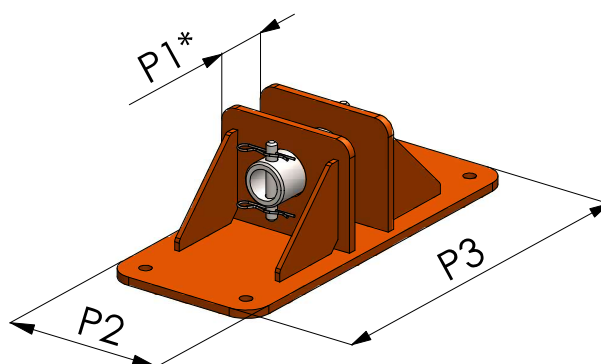

| CODE | P1* (mm) | P2 (mm) | P3 (mm) |
|---------------|----------|---------|---------|
| 831BMP2010020 | 20 | 140 | 300 |
| 831BMP2010025 | 25 | 140 | 300 |
| 831BMP2010030 | 30 | 140 | 300 |
| 831BMP2015035 | 35 | 140 | 300 |
| 831BMP2024045 | 45 | 160 | 380 |
| 831BMP2034045 | 45 | 160 | 380 |
| 831BMP2034050 | 50 | 160 | 380 |
| 831BMP2050060 | 60 | 240 | 550 |
| 831BMP2070060 | 60 | 240 | 550 |
| 831BMP2110090 | 90 | 240 | 550 |
| 831BMP2110100 | 100 | 240 | 550 |

P1*: Nominal dimension, non-binding value.

OX & RUD LIFTING SOLUTIONS, S.L.

OX, as a brand of the CFB group, was created in 1993, and in 2024 we joined a huge company, RUD Ketten Rieger & Dietz GmbH u. Co. KG., with the mission of offering and bringing to all countries the best solutions for the transport and lifting of loads in a controlled and safe way in any industrial, naval, railway, wind, oil & gas, offshore, automotive, aeronautical and small industries. Now, more than ever, closer to the customer, with distributors and branches on all five continents.

At OX & RUD, engineering, experience and advice are the bases of our quality.

OX & RUD, now bigger, stronger, better.

CERTIFICATES

We have managed to manufacture and distribute machinery that meets the highest standards.

For this, it is an essential requirement to pass all quality controls, which is why we have the following certifications:

- **ISO 9001:2015**
- **EN ISO 3834-2:2006 (Welding)**

OX & RUD is Lloyd Register Quality Assurance certified, in order to comply with all regulations, standards and norms of the European Union

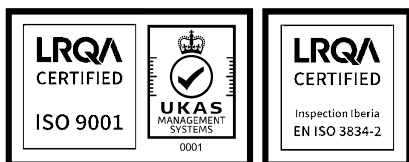

"Our priority is to provide effective, profitable and safe solutions, to ensure long-term business relationships, through customer satisfaction".

Emilio Blasco
Founder

**YOUR TRUSTED
PARTNER FOR
HEAVY LIFTING
SOLUTIONS**